

11TH DRESDEN SYMPOSIUM ON AUTOANTIBODIES

DRESDEN, SEPTEMBER 1–4, 2013
CRTD – 01307 DRESDEN, FETSCHERSTRASSE 105



FINAL PROGRAMME

The congress venue 2013: Centre for Regenerative Therapies (CRTD) in 01307 Dresden, Fetscherstrasse 105
(picture: Clemens A. Schulze Lohoff)



WELCOME

Dear Colleagues,

On behalf of the Organizing Committee it is a great pleasure to welcome you to our 11th Dresden Symposium on Autoantibodies. The Symposium is organised by the Institute of Immunology of the Medical Faculty of the Technical University Dresden in cooperation with the Association for the Advancement of Immune Diagnostics (www.gfid-ev.de) and the Section Immunodiagnosics of the German Society for Clinical Chemistry and Laboratory Medicine (www.dgkl.de). The symposium intends to bring together clinicians of different disciplines, immunologists and basic researchers for discussion of the various aspects of the induction, pathogenetic role and clinical relevance of autoantibodies. The current symposium entitled "Infections, Tumors and Autoimmunity" will focus on manifold aspects of autoimmunity in infections and tumors, novel aspects in the pathogenesis of autoimmune diseases, paraneoplastic and tumor associated autoantibodies, autoantibodies in systemic autoimmune rheumatic and neurological diseases, the standardization/harmonization of autoimmune diagnostics and other methodical aspects of autoantibody testing.

We would like to express our thanks to the members of the International Advisory Board and to the active contributors who will present their latest achievements as well as to the many sponsors who enabled this symposium. The organizers of the symposium are deeply indebted to the Center of Regenerative Medicine (CRTD) and in particular to the Director of the CRTD, Professor Michael Brand and to Professor Ezio Bonifacio, for placing at our disposal this wonderful congress venue.

We expect that our 11th Dresden Symposium on Autoantibodies will stimulate a broad debate how the new achievements from the bench work could help to improve diagnostics and therapy of autoimmune diseases. We hope that you will enjoy the scientific programme and your stay in Dresden.

Karsten Conrad
On behalf of the Organizing Committee

SUNDAY
SEPTEMBER 01

PROGRAMME

12.00–21.00

Registration

HALL A

14.00–14.30

Welcome and Introduction

14.30–16.00

INFECTIONS AND AUTOIMMUNITY

Co-Chairs: K. Conrad (Dresden, Germany)

Y. Shoenfeld (Tel Hashomer, Israel)

14.30–15.10

The ASIA syndrome: Adjuvants in infections, silicone and vaccines; autoimmunity and cancer

Yehuda Shoenfeld (Tel Hashomer, Israel)

15.10–15.35

Possible role of infections in the pathogenesis of autoimmune liver diseases

Dimitrios Bogdanos (London, UK)

15.35–16.00

GP2 – The link between innate and acquired immune system in the intestine

Dirk Roggenbuck, Dimitrios Bogdanos, Dirk Reinhold, Karsten Conrad (Senftenberg, Germany)

16.00–16.30

COFFEE BREAK – POSTER AND EXHIBITION VIEWING

HALL A

16.30–18.00

PATHOGENESIS OF AUTOIMMUNE DISEASES – NOVEL ASPECTS

Co-Chairs: E.K.L. Chan (Gainesville, USA)

E. Csernok (Lübeck, Germany)

16.30–17.10

Neutrophil extracellular traps – From infection to autoimmunity

Arturo Zychlinsky (Berlin, Germany)

17.10–17.35

Aggregation of NETs: flipping the switch to resolution of inflammation

Markus Hoffmann, Martin Herrmann, Christine Schorn, Luis Munoz (Erlangen, Germany)

17.35–18.00

Memory plasma cells in autoimmunity – An update

Falk Hiepe (Berlin, Germany)

18.00

Welcome Reception

HALL A

NETOSIS, IMMUNODEFICIENCY AND AUTOIMMUNITY

Co-Chairs: G.J.M. Pruijn (Nijmegen, The Netherlands)
L.E.C. Andrade (São Paulo, Brazil)

09.00–10.20

NETs: the missing link between cell death and systemic autoimmune diseases?

Felipe Andrade (Baltimore, USA)

09.00–09.30

NETs and ANCA-associated vasculitides

Elena Csernok (Lübeck, Germany)

09.30–09.55

The interface between primary immunodeficiency and systemic lupus erythematosus

Luis E.C. Andrade (São Paulo, Brazil)

09.55–10.20

COFFEE BREAK – POSTER AND EXHIBITION VIEWING

Poster viewing

P1-P15 Contributions of the candidates for the Dresden Prize on the Study of Autoantibodies

10.20–11.00

HALL A

AUTOIMMUNITY IN INFECTIONS AND TUMORS

Co-Chairs: C.A. Casiano (Loma Linda, USA)
K. Conrad (Dresden, Germany)

11.00–12.30

Vitamin D in infection, autoimmunity and cancer

Yehuda Shoenfeld (Tel Hashomer, Israel)

11.00–11.30

Target of autoantibody in HCV patients during interferon/ribavirin therapy

Edward K.L. Chan (Gainesville, USA)

11.30–11.45

Novel vaccine against autoimmunity – harnessing parasitic infection for autoimmunity and cancer

Miri Blank (Tel Hashomer, Israel)

11.45–12.00

Hyper-ferritinemic syndrome in infection and autoimmunity

Cristina Rosario (Matosinhos, Portugal)

12.00–12.15

The fate of the Ro autoantigen associated YRNAs in Cox-sackievirus-infected cells

Ger J.M. Pruijn (Nijmegen, The Netherlands)

12.15–12.30

MONDAY
SEPTEMBER 02

11.00–12.30

HALL B
IMMUNE REACTIONS AGAINST BIOLOGICAL DRUGS

Co-Chairs: A. Kromminga (Hamburg, Germany)
M. Tovey (Paris, France)

11.00–11.30

Clinical relevance of anti-drug antibodies
Arno Kromminga (Hamburg, Germany)

11.30–12.00

Immunogenicity testing of recombinant hGH – Methodological challenges and clinical relevance
Michael Schaab (Leipzig, Germany)

12.00–12.30

Quantification of the activity and neutralizing antibody response to TNF-alpha antagonists
Michael Tovey (Paris, France)

12.30–14.30

LUNCH BREAK – POSTER AND EXHIBITION VIEWING
Poster viewing
P16-P38 Systemic Autoimmune Diseases –
Methodical Aspects

12.30–14.30

EASI LUNCH MEETING (meeting room)
(EASI members only)

14.30–15.50

HALL A
**PRESENTATIONS OF THE CANDIDATES FOR THE
DRESDEN PRIZE ON THE STUDY OF AUTOANTIBODIES**

(in alphabetical order of the presenting authors)
Co-Chairs: K. Conrad (Dresden, Germany)
T. Krieger (Hamburg, Germany)

14.30–14.40

Detection of anti-phospholipase A2 receptor autoantibodies:
A comparison of three different immunoassays
Astrid Behnert, Mario Schiffer, Michael Mahler, Marvin J. Fritzler (Hannover, Germany)

14.40–14.50

Effects of intracellular glutamine levels on the reversible
assembly of cytoplasmic rod and ring autoantigenic structures
S. John Calise, Wendy C. Carcamo, Claire Krueger, Daniel L. Purich, and Edward K.L. Chan (Gainesville, USA)

Generation of stable HEp2 cell line M4 expressing human muscle-specific kinase for automatic videoscanner-based immunofluorescence diagnostics of Myasthenia gravis
Sandra George, S. Paulick, Ilka Knütter, Nadja Röber, Rico Hiemann, Dirk Roggenbuck, Karsten Conrad and Jan-Heiner Küpper (Senftenberg, Germany)

14.50–15.00

CytoBead – A novel platform for multiparametric analyses
Rico Hiemann, Mandy Sowa, Ilka Knütter, Kai Grossmann, Nadja Röber, Karsten Conrad, Dirk Roggenbuck (Senftenberg, Germany)

15.00–15.10

Mycophenolic acid and ribavirin induce cytoplasmic Rods and Rings (RR) structures in vivo, but only ribavirin induces anti-RR autoantibodies
Gerson D. Keppeke, Sandro F. Perazzio, Monica S. Prado, Edward K.L. Chan, Luis Eduardo C. Andrade (São Paulo, Brazil)

15.10–15.20

Anti-AT₁R and anti-ET_AR autoantibodies from patients with SSc and their agonistic effects
Angela Kill, Christoph Tabeling, Anja A. Kühl, J. Günther, M.O. Becker, Harald Heidecke, D. Dragun, G.R. Burmester, G. Riemekasten (Berlin, Germany)

15.20–15.30

Towards understanding the pathogenesis of granulomatosis with polyangiitis: The role of neutrophil extracellular traps
Christina Lange, E. Csernok and J.U. Holle (Bad Bramstedt, Germany)

15.30–15.40

Evaluation of a novel sensitive and specific Lateral Flow Assay (LFA) for the detection of anti-dsDNA antibodies
Nadine Offermann, M. Petschinka and M. Fooke (Neuss, Germany)

15.40–15.50

COFFEE BREAK – POSTER AND EXHIBITION VIEWING

15.50–16.30

**HALL A
PRESENTATIONS OF THE CANDIDATES FOR THE
DRESDEN PRIZE ON THE STUDY OF AUTOANTIBODIES**

16.30–17.40

(in alphabetical order of the presenting authors)

Co-Chairs: R. Lange (Berlin, Germany)

D. Reinhold (Magdeburg, Germany)

MONDAY
SEPTEMBER 02

- 16.30–16.40 What is the clinical significance of anti-Sm-antibodies in SLE patients? A comparison with anti-dsDNA-antibodies and C3
Alexandra Richartz, Thomas Rose, Cornelia Dähnrich, Anke Rosemann, Fidan Barkhudarova, Wolfgang Schlumberger, Gerd-Rüdiger Burmester, Karl Egerer, Robert Biesen and Falk Hiepe (Berlin, Germany)
- 16.40–16.50 Development of a method for multiplex real-time analysis of enzymatic activity on a microbead-chip
Stefan Rödiger, Alexander Böhm, Jörg Nitschke, Luba Stavitskaya, Melanie Gruner, Alena V. Kundzer, Margarita V. Volkova, I. Generalov, Carsten Schmidt, Christian Schröder, Dirk Roggenbuck, Peter Schierack (Senftenberg, Germany)
- 16.50–17.00 Quantitative results of automated indirect immunofluorescence enable value added reporting for antinuclear antibody testing
Sofie Schouwers, Myriam Bonnet, Patrick Verschueren, René Westhovens, Daniel Blockmans, Godelieve Mariën, Xavier Bossuyt (Leuven, Belgium)
- 17.00–17.10 CytoBead ANCA – a novel indirect immunofluorescence test for the simultaneous detection of anti-neutrophil cytoplasmic antibodies
Mandy Sowa, Ilka Knütter, Kai Grossmann, Rico Hiemann, Nadja Röber, Dirk Reinhold, Elena Csernok, Ursula Anderer, Karsten Conrad, Dirk Roggenbuck (Senftenberg, Germany)
- 17.10–17.20 PR3-ANCA as a promising biomarker for the diagnosis of primary sclerosing cholangitis (PSC)
Laura M. Stinton, Chelsea Bentow, Michael Mahler, Gary L. Norman, Bertus Eksteen, Andrew L. Mason, Gilaad G. Kaplan, Bjorn Lindkvist, Angela Cheung, Harry Janssen, Marvin J. Fritzler (Calgary, Canada)
- 17.20–17.30 Anti-M-type phospholipase A2 receptor (PLA2r) antibodies in diagnosis and follow-up of idiopathic membranous nephropathy (IMN)
S. Glionna, L. Bianchi, Barbara Trezzi, M. D'Amico, T. Stellato, D. Santoro, R.A. Sinico, A. Radice (Milan, Italy)
- 17.30–17.40 Role of autoantibodies against Zinc transporter protein (anti-ZnT8) in the diagnosis and follow-up of type I Diabetes Mellitus: an Italian experience
Silvia Zago, M. Fabris, P. Melli, M. Zanatta, T. Basso, A. Comici, E. Carlin, G. Zanette, E. Tonutti, A. Rosolen (Udine, Italy)

HALL A

AUTOANTIBODIES IN CONNECTIVE TISSUE DISEASES

Co-Chairs: P.L. Meroni (Milan, Italy)
M. Mahler (San Diego, USA)

Anti-Mup44 autoantibodies in inclusion-body myositis
Ger J.M. Pruijn (Nijmegen, The Netherlands)

Autoantibody profiling in idiopathic inflammatory myopathies: Validation of the myositis antigens Mi-2a, MDA5, NXP2 and SAE1 in a line immunoassay
L. Komorowski, W. Meyer, T. Scheper, W. Schlumberger, A. Ott, P.J. Charles, C. Probst (Lübeck, Germany)

Autoantibodies to 3-hydroxy-3-methylglutaryl-Coenzyme A reductase (HMGCR) a novel biomarker for statin associated necrotizing myopathies
Makoto Miyara, Olivier Benveniste, Jean-Luc Charuel, Alexander Shikhman, Olivier Boyer, Joe Philips, Lucile Musset, Michael Mahler (San Diego, USA)

Autoantibody signatures of connective tissue disease patients identified with a bead-based assays approach
Angelika Lueking, Petra Budde, Heike Goehler, Jessica Schwermann, Martin Gamer, Klaus Marquardt, Anna Telaar, Daniel Chamrad, Carmen Theek, Matthias Schneider, Peter Schulz-Knappe (Dortmund, Germany)

Identification of novel autoantibody signatures reflecting the heterogeneity of systemic lupus erythematosus
Petra Budde, A. Lueking, S. Vordenbäumen, H. Göhler, M. Gamer, K. Marquardt, A. Telaar, D. Chamrad, C. Theek, B. Ostendorf, P. Schulz-Knappe, M. Schneider (Dortmund, Germany)

HALL B

AUTOANTIBODIES IN NEUROLOGICAL DISEASES

Co-Chairs: D. Roggenbuck (Senftenberg, Germany)
V. Somers (Diepenbeek, Belgium)

Autoantibodies against coronin-1a in clinically isolated syndrome and multiple sclerosis
Veerle Somers (Diepenbeek, Belgium)

09.00–10.20

09.00–09.20

09.20–09.35

09.35–09.50

09.50–10.05

10.05–10.20

09.00–10.30

09.00–09.20

TUESDAY
SEPTEMBER 03

- 09.20–09.40 Diagnostic and pathophysiologic relevance of autoantibodies against aquaporin-4
Friedemann Paul, Brigitte Wildemann, Sven Jarius (Berlin, Germany)
- 09.40–10.00 Autoantibodies against the neuronal surface antigen DPPX: markers for an emerging neurological disease entity
Bettina Balint, Simon Nagel, Uwe Haberkorn, Christian Probst, Inga-Madeleine Blöcker, Bianca Teegen, Kristin Rentzsch, Ramona Bahtz, Lars Komorowski, Sandra Saschenbrecker, Andreas Kastrup, Martin Kuthe, Hans-Michael Meinck, Winfried Stöcker (Lübeck, Germany)
- 10.00–10.30 New autoantibodies in multiple sclerosis
Bernhard Hemmer (Munich, Germany)
- 10.30–11.00 COFFEE BREAK – POSTER AND EXHIBITION VIEWING
- HALL A**
- 11.00–12.30 PATHOGENESIS AND THERAPY OF AUTOIMMUNE DISEASES – NOVEL ASPECTS**
Co-Chairs: D. Bogdanos (London, UK)
F. Hiepe (Berlin, Germany)
- 11.00–11.25 Inherited defects in nucleic acid metabolism and autoimmunity
Min Ae Lee-Kirsch (Dresden, Germany)
- 11.25–11.50 Induction of autoimmunity by defects of intracellular nucleases: Mouse models for Aicardi-Goutières syndrome
Axel Roers (Dresden, Germany)
- 11.50–12.15 Protective natural autoantibodies in atherogenesis and autoimmunity
Gregg J. Silverman (New York, USA)
- 12.15–12.30 The use of Aptamers as a new tool for the treatment of autoantibody associated diseases
G. Wallukat, A. Haberland, S. Berg, E.J. Freyse, E. Salzsieder, W. Schulze, I. Schimke (Berlin, Germany)

HALL B

AUTOANTIBODIES IN RHEUMATOID ARTHRITIS

Co-Chairs: M.J. Fritzler (Calgary, Canada)
G. Steiner (Vienna, Austria)

11.00–12.30

Serological pre-RA diagnostics
Günter Steiner (Vienna, Austria)

11.00–11.30

Antibodies against carbamylated proteins in different stages
of rheumatoid arthritis
Leendert A. Trouw (Leiden, The Netherlands)

11.30–12.00

Development and initial use of a multiplex chip-based
assay for the detection of autoantibodies against citrullinated
peptides in rheumatoid arthritis patients
Johan Rönnelid (Uppsala, Sweden)

12.00–12.30

LUNCH BREAK – POSTER AND EXHIBITION VIEWING
Poster viewing

12.30–14.00

P39-P54 Organ Specific Autoimmune Diseases –
Methodical Aspects

GFID MEETING (BioInnovationszentrum room 5604)
(GFID members only)

13.00–14.00

HALL A

EASI SYMPOSIUM

**STANDARDIZATION/HARMONIZATION IN AUTO-
IMMUNE DIAGNOSTICS**

Co-Chairs: Y. Shoenfeld (Tel Hashomer, Israel)
U. Sack (Leipzig, Germany)

14.00–15.50

Standardization of reference material for autoantibody
testing: the state of the art
Pier Luigi Meroni (Milan, Italy)

14.00–14.30

International recommendations for the assessment of auto-
antibodies to cellular antigens referred to as anti-nuclear
antibodies (ANA)

14.30–14.50

Jan Damoiseaux (Maastricht, The Netherlands)

TUESDAY
SEPTEMBER 03

- 14.50–15.10 Reading and interpretation of ANA-immunofluorescence tests: results of a comparative study with 6 automated systems
Nicola Bizzaro (Tolmezzo, Italy)
- 15.10–15.30 ANA measurement by IIF in comparison to other methods in the diagnosis of connective tissue diseases
Xavier Bossuyt (Leuven, Belgium)
- 15.30–15.50 ANA questionnaires in Europe (results and possible consequences)
Jan Damoiseaux (Maastricht, The Netherlands)
- 15.50–16.30 COFFEE BREAK
- 16.30–17.00 DRESDEN PRIZE ON THE STUDY OF AUTOANTIBODIES**
Award Ceremony
- 17.15 Departure to Albrechtsberg Castle
- 17.45 Musical Champagne Reception and visit of the Castle
- 18.30 Social Dinner

HALL A

METHODICAL ASPECTS OF AUTOANTIBODY TESTING

Co-Chairs: N. Bizzaro (Tolmezzo, Italy)
X. Bossuyt (Leuven, Belgium)

Toward new concepts and approaches to autoantibody testing
Marvin J. Fritzler (Calgary, Canada)

New (automated) assays for screening and monitoring auto-immune diseases
Boris Gilburd (Tel Hashomer, Israel)

Evaluation of a new ELISA for the determination of auto-antibodies against human M-type phospholipase A2 receptor in primary membranous nephropathy
W. Schlumberger, C. Dähnrich, C. Probst, B. Seitz-Polski, V. Esnault, J.F. Wetzels, J.M. Hofstra, E. Hoxha, R.A. Stahl, G. Lambeau, W. Stöcker, L. Komorowski (Lübeck, Germany)

Comparison of two ELISAs for the detection of anti-MZGP2 antibodies as a new serological marker for Crohn's disease
Laura M. Stinton, Gary L. Norman, Zakera Shums, Maria T. Arias-Loste, Marcos Lopez-Hoyos, Michael Mahler (Calgary, Canada)

HALL B

PARANEOPLASTIC AND TUMOR ASSOCIATED AUTO-ANTIBODIES

Co-Chairs: Edward K.L. Chan (Gainesville, USA)
T. Krieger (Hamburg, Germany)

Proteomic profiling of autoantibodies in prostate cancer: a health disparities perspective
Carlos Casiano (Loma Linda, USA)

Characterisation of novel autoantibody biomarkers in oncology and autoimmunity
Will Colón, Colin Wheeler, Ezam Uddin, Nicholas Workman, Pooja Agashe, Tim Vyse and Michael B. McAndrew (Oxford, UK)

09.00–10.30

09.00–09.40

09.40–10.00

10.00–10.15

10.15–10.30

09.00–10.30

09.00–09.30

09.30–10.00

WEDNESDAY
SEPTEMBER 04

- 10.00–10.15 Multi-parametric recombinant cell-based indirect immunofluorescence assay (RC-IFA) for the determination of auto-antibodies associated with paraneoplastic neurological syndromes
Inga-Madeleine Blöcker, Christiane Radzimski, Mandy Unger, Linda Döring, Winfried Stöcker, Josep Dalmau, Peter Sillevs Smitt, Lars Komorowski, Christian Probst (Lübeck, Germany)
- 10.15–10.30 Development of sensitive and specific assays for serological diagnosis of anti-laminin 332 mucous membrane pemphigoid
S. Groth, A. Abadpour, K. Vafia, C. Probst, L. Komorowski, W. Schlumberger, W. Stöcker, D. Zillikens and E. Schmidt (Lübeck, Germany)
- 10.30–11.00 COFFEE BREAK – POSTER AND EXHIBITION VIEWING
- HALL A**
- 11.00–12.40 THE RENAISSANCE OF THE HEP-2 CELL ASSAY**
Co-Chairs: R.L. Humbel (Esch-sur-Alzette, Luxembourg)
J. Damoiseaux (Maastricht, The Netherlands)
- 11.00–11.30 Standardization of ANA-HEp-2 pattern nomenclature
Luis E.C. Andrade (São Paulo, Brazil)
- 11.30–11.50 The clinical significance of the dense fine speckled immunofluorescence pattern on HEp-2 cells in the diagnosis of systemic autoimmune disease
Michael Mahler (San Diego, USA)
- 11.50–12.10 Rare staining pattern on HEp-2 cells
René Louis Humbel (Esch-sur-Alzette, Luxembourg)
- 12.10–12.25 Optimization of the automated HEp-2 cell assay by stepwise improvement of software algorithms
Rico Hiemann, Nadja Röber, Dirk Roggenbuck, Karsten Conrad (Senftenberg, Germany)
- 12.25–12.40 Anti-nematin antibodies in practice
J. Goetz, R. L. Humbel, G. Uettwiller, F. Habersetzer, M. Doffoel (Strasbourg, France)

WEDNESDAY
SEPTEMBER 04

LUNCH BREAK

12.40–13.30

HALL A

EASI/GFID Symposium for General Practitioners
(in German)

13.30–15.30

AUTOIMMUNDIAGNOSTIK IN DER KLINISCHEN PRAXIS

Vorstellung des Buches „Autoimmunerkrankungen für
Praktische Ärzte“
Ulrich Sack (Leipzig)

Autoimmunerkrankungen in der klinischen Praxis
Manfred Herold (Innsbruck)

Serologische Diagnostik von Autoimmunerkrankungen
Karsten Conrad (Dresden)

COFFEE BREAK

15.30–16.00

Meeting of the German and Austrian EASI Group
(in German)

16.00–17.30

SUNDAY,
SEPTEMBER 01
(14.00)
UNTIL
WEDNESDAY,
SEPTEMBER 04
(13.30)

POSTER EXHIBITION

Poster presentations of the candidates for the Dresden Prize on the Study of Autoantibodies (in alphabetical order of presenting author)

- P1** Detection of anti-phospholipase A2 receptor autoantibodies: A comparison of three different immunoassays
Astrid Behnert, Mario Schiffer, Michael Mahler, Marvin J. Fritzler (Hannover, Germany)
- P2** Effects of intracellular glutamine levels on the reversible assembly of cytoplasmic rod and ring autoantigenic structures
S. John Calise, Wendy C. Carcamo, Claire Krueger, Daniel L. Purich, and Edward K.L. Chan (Gainesville, USA)
- P3** Generation of stable HEp2 cell line M4 expressing human muscle-specific kinase for automatic video-scan-based immunofluorescence diagnostics of Myasthenia gravis
Sandra George, S. Paulick, Ilka Knütter, Nadja Röber, Rico Hiemann, Dirk Roggenbuck, Karsten Conrad and Jan-Heiner Küpper (Senftenberg, Germany)
- P4** CytoBead – A novel platform for multiparametric analyses
Rico Hiemann, Mandy Sowa, Ilka Knütter, Kai Grossmann, Nadja Röber, Karsten Conrad, Dirk Roggenbuck (Senftenberg, Germany)
- P5** Mycophenolic acid and ribavirin induce cytoplasmic Rods and Rings (RR) structures in vivo, but only ribavirin induces anti-RR autoantibodies
Gerson D. Keppeke, Sandro F. Perazzio, Monica S. Prado, Edward K.L. Chan, Luis Eduardo C. Andrade (São Paulo, Brazil)
- P6** Anti-AT₁R and anti-ET_AR autoantibodies from patients with SSc and their agonistic effects
Angela Kill, Christoph Tabeling, Anja A. Kühl, J. Günther, M.O. Becker, Harald Heidecke, D. Dragun, G.R. Burmester, G. Riemekasten (Berlin, Germany)

- P7** Towards understanding the pathogenesis of granulomatosis with polyangiitis: The role of neutrophil extracellular traps
Christina Lange, E. Csernok and J. U. Holle (Bad Bramstedt, Germany)
- P8** Evaluation of a novel sensitive and specific Lateral Flow Assay (LFA) for the detection of anti-dsDNA antibodies
Nadine Offermann, M. Petschinka and M. Fooke (Neuss, Germany)
- P9** What is the clinical significance of anti-Sm-antibodies in SLE patients? A comparison with anti-dsDNA-antibodies and C3
Alexandra Richartz, Thomas Rose, Cornelia Dähnrich, Anke Rosemann, Fidan Barkhudarova, Wolfgang Schlumberger, Gerd-Rüdiger Burmester, Karl Egerer, Robert Biesen and Falk Hiepe (Berlin, Germany)
- P10** Development of a method for multiplex real-time analysis of enzymatic activity on a microbead-chip
Stefan Rödiger, Alexander Böhm, Jörg Nitschke, Luba Stavitskaya, Melanie Gruner, Alena V. Kundzer, Margarita V. Volkova, I. Generalov, Carsten Schmidt, Christian Schröder, Dirk Roggenbuck, Peter Schierack (Senftenberg, Germany)
- P11** Quantitative results of automated indirect immunofluorescence enable value added reporting for anti-nuclear antibody testing
Sofie Schouwers, Myriam Bonnet, Patrick Verschueren, René Westhovens, Daniel Blockmans, Godelieve Mariën, Xavier Bossuyt (Leuven, Belgium)
- P12** CytoBead ANCA – a novel indirect immunofluorescence test for the simultaneous detection of anti-neutrophil cytoplasmic antibodies
Mandy Sowa, Ilka Knütter, Kai Grossmann, Rico Hiemann, Nadja Röber, Dirk Reinhold, Elena Csernok, Karsten Conrad, Dirk Roggenbuck (Senftenberg, Germany)

SUNDAY,
SEPTEMBER 01
(14.00)
UNTIL
WEDNESDAY,
SEPTEMBER 04
(13.30)

SUNDAY,
SEPTEMBER 01
(14.00)
UNTIL
WEDNESDAY,
SEPTEMBER 04
(13.30)

- P13** PR3-ANCA as a promising biomarker for the diagnosis of primary sclerosing cholangitis (PSC)
Laura M. Stinton, Chelsea Bentow, Michael Mahler, Gary L. Norman, Bertus Eksteen, Andrew L. Mason, Gilaad G. Kaplan, Bjorn Lindkvist, Harry Janssen, Marvin J. Fritzler (Calgary, Canada)
- P14** Anti-M-type phospholipase A2 receptor (PLA2r) antibodies in diagnosis and follow-up of Idiopathic Membranous Nephropathy (IMN)
S. Glionna, L. Bianchi, Barbara Trezzi, M. D'Amico, T. Stellato, D. Santoro, R. A. Sinico, A. Radice (Milan, Italy)
- P15** Role of autoantibodies against Zinc transporter protein (anti-ZnT8) in the diagnosis and follow-up of type I Diabetes Mellitus: an Italian experience
Silvia Zago, M. Fabris, P. Melli, M. Zanatta, T. Basso, A. Comici, E. Carlin, G. Zanette, E. Tonutti, A. Rosolen (Udine, Italy)

Systemic Autoimmune Diseases – Methodical Aspects

- P16** Efficient autoantibody titration using indirect immunofluorescence assays (IIFA)
Jan Martinek, Ivo Lochman, Alexandra Lochmanová, Vladimír Krauz (Ostrava, Czech Republic)
- P17** Autoimmunity diagnostic strategies (ANA, anti-dsDNA, anti-ENA) in Italian clinical laboratories
A. Radice, L. Bianchi, S. Glionna, B. Trezzi, on behalf of Forum Interdisciplinare per la Ricerca sulle Malattie Autoimmuni (F.I.R.M.A) (Milan, Italy)
- P18** Evaluation of ANA testing results: is there a need for revision of our protocol for antibody specificity testing?
Andrea Tesija Kuna, Ines Vukasovic, Nada Vrkic (Zagreb, Croatia)
- P19** Automation in ANA HEp-2 cells microscopy: can the machine substitute the human eye?
Cristovão Pitangueira Mangueira, Eliane Aparecida Rosseto (São Paulo, Brazil)

- P20** HELIOS, a bright future for ANA – automated indirect immunofluorescence (IIF) assay
B. Gilburd, N. Agmon-Levin, T. Martins, Andrea Petzold, T. Matthias and Y. Shoenfeld (Tel-Aviv, Israel)
- P21** Comparability of the AESKUSLIDES ANA-HEp-2 antinuclear antibody (ANA) immunological test system with a commercially available system
Torsten Matthias, Sascha Pfeiffer, Trishna Martins, Peter Trinder and Andrea Petzold (Wendelsheim, Germany)
- P22** CytoBead ANA – a novel indirect immunofluorescence test for the simultaneous detection of anti-nuclear antibodies
Juliane Scholz, Ilka Knütter, Kai Grossmann, Rico Hiekmann, Mandy Sowa, Nadja Röber, Karsten Conrad, Dirk Roggenbuck (Senftenberg, Germany)
- P23** Microtiter plate-based multiparametric assay for detection of non-organ specific autoantibodies
Jana Langer, Erik Höchel, Klemens Löster, Martin Eberhardt, Nadja Röber, Karsten Conrad, Silvia Porstmann, Tomas Porstmann (Heidesee, Germany)
- P24** Evaluation of a novel chemiluminescent assay (QUANTA Flash® CTD Screen Plus) for the rapid detection of autoantibodies in systemic autoimmune rheumatic diseases
C. Bentow, A. Seaman, A. Swart, A. Shikhman, N. Goodman, M. Mahler (San Diego, USA)
- P25** Prevalence and clinical associations of anti-DFS70 antibodies in samples with high titer of ANA but without detectable fine-specificity
Michael Mahler, Sofie Schouwens, Roger Albesa, Eric Tena, Nathalie Vandeputte, Doreen Dillaerts, X. Bossuyt (Leuven, Belgium)
- P26** LEDGF antibodies and DFS pattern in routine diagnostics
Uwe Höpner, Tim Fülling, Uta Kießling, Teresa Trimpop, Manuela Rejzek, Andrea Thieme, Nadja Röber, Karsten Conrad (Dresden, Germany)

SUNDAY,
SEPTEMBER 01
(14.00)
UNTIL
WEDNESDAY,
SEPTEMBER 04
(13.30)

SUNDAY,
SEPTEMBER 01
(14.00)
UNTIL
WEDNESDAY,
SEPTEMBER 04
(13.30)

- P27** Longitudinal study of anti-DFS70 antibodies in 5 patients without antinuclear antibody associated autoimmune rheumatic disease
Sofie Schouwers, Michael Mahler, Doreen Dilaerts, Nathalie Vandeputte, Xavier Bossuyt (Leuven, Belgium)
- P28** Evaluation of the first dot blot assay for the detection of anti DFS 70 antibodies as part of a 12plex ANA Profile
Johannes Schulte-Pelkum, Eric Tena, Alain Vigneron, Nicolas Bodart, Michael Mahler (San Diego, USA)
- P29** Novel autoantibodies showing chromatin binding in the HEp-2 cell assay
Angelika Lueking, Heike Goehler, Petra Rengers, Martin Gamer, Klaus Marquardt, Petra Budde, Anna Telaar, Daniel Chamrad, Carmen Theek, Karsten Conrad and Peter Schulz-Knappe (Dortmund, Germany)
- P30** Evaluation of ANCA by Automated IFA Image Analysis on NOVA View®
Carol E. Buchner, Cassandra C. Bryant, Rachel A. Rosenblum, Marlene Gonzalez, Gabriella Lakos (San Diego, USA)
- P31** Evaluation of recombinant TIF1 γ in a line immune assay for the detection of autoantibodies in idiopathic inflammatory myopathies
C. Probst, L. Komorowski, W. Meyer, T. Scheper, A. Ott, P.J. Charles, K. Danko, L. Bodoky, H. Chinoy, W. Schlumberger (Lübeck, Germany)
- P32** The anti-CCP2 is the anti-citrullinated protein antibody (ACPA) with highest diagnostic value in rheumatoid arthritis
E. Grenmyr and Y. Sommarin (Malmö, Sweden)
- P33** Occurrence of anti-RA33 antibody in various types of juvenile idiopathic arthritis
Gabor Nagy, Barbara Szasz, Diana Garan, Ibolya Szollosi, Sandor Sipka, Tamas Constantin (Debrecen, Hungary)

SUNDAY,
SEPTEMBER 01
(14.00)
UNTIL
WEDNESDAY,
SEPTEMBER 04
(13.30)

- P34** Clinical evaluation of total and high avidity anti-dsDNA antibody EIA for the diagnosis of systemic lupus erythematosus
Pengjie Wan, Shuxia Zhou, Hua Cao, Weiping Li, Doug Scott, Joel Hardy, Tony Presitigiacomo, Jie Zheng (Hercules, USA)
- P35** Significance of anti-C1q antibody detection in SLE patients with lupus nephritis
Ivana Stiborová, Vlastimil Král, Stanislava Blažičková (Usti nad Labem, Czech Republic)
- P36** MMP-3 is a marker for disease activity in rheumatoid arthritis
S. Reuter, T. Matthias (Wendelsheim, Germany)
- P37** The conversion of QuantiFERON TB Gold test during biological treatment by anti-TNF preparations
E. Zanova, D. Kozakova, I. Rybar, I. Solovic, J. Rovensky (Piestany, Slovak Republic)
- P38** Interferon-gamma and QuantiFERON-TB Gold test conversion during biological treatment
D. Kozakova, E. Zanova, I. Rybar, I. Solovic, J. Rovensky (Piestany, Slovak Republic)

Organ Specific Autoimmune Diseases – Methodical Aspects

- P39** Nonradioactive determination of autoantibodies against acetylcholine receptors in myasthenia gravis: A new enzyme-linked immunoassay for manual and automated processing
J. Westermann, E. Denczyk, C. Probst, L. Komorowski, W. Schlumberger (Lübeck, Germany)
- P40** Clinical validation of a novel immunofluorescence assay for the detection of anti-MuSK antibodies based on MuSK transfected HEp-2 cells
Nadja Röber, Silke Weber, Jochen Schäfer, Sandra George, Ilka Knütter, Dirk Roggenbuck, Jan-Heiner Küpper, Karsten Conrad (Dresden, Germany)

SUNDAY,
SEPTEMBER 01
(14.00)
UNTIL
WEDNESDAY,
SEPTEMBER 04
(13.30)

- P41** Pleural mesothelioma and anti-MA2-associated encephalitis
Adriano Jiménez-Escrig, Silvia Medina, Ángela Carrasco (Madrid, Spain)
- P42** What should be the cut-off for VGKC complex antibodies?
Sylvie Coito, René-Louis Humbel (Esch-Sur-Alzette, Luxembourg)
- P43** Multi-center validation study of DNER as the target of anti-PCA-Tr autoantibodies associated with paraneoplastic neurological syndrome
Kristin Rentzsch, Inga-Madeleine Blöcker, Bianca Teegen, Winfried Stöcker, Francesc Graus, Véronique Rogemond, Jérôme Hönnorat, Esther S.P. Hulsboom, Peter A.E. Sillevs Smitt, Christian Probst, Lars Komorowski (Lübeck, Germany)
- P44** Prevalence of anti-nuclear antibodies in patients with primary biliary cirrhosis
Ana Kozmar, Ivan Padjen, Miroslav Mayer, Mirna Sentic, Branko Malenica (Zagreb, Croatia)
- P45** Preliminary report: Detection of antibodies against D-3-phosphoglycerate dehydrogenase (PGDH) in autoimmune liver diseases using a line immune assay
W. Meyer, C. Probst, L. Komorowski, A. Ott, T. Scheper, W. Schlumberger, W. Stöcker and H. Yan (Lübeck, Germany)
- P46** Can the HEp-2 cell assay replace the indirect immunofluorescence on rat cryostat section for AMA-M2 screening?
Kristin Kühnert, Uta Kießling, Teresa Trimpop, Manuela Rejzek, Andrea Thieme, Nadja Röber, Karsten Conrad (Dresden, Germany)
- P47** Evaluation of a high sensitive assay for the diagnosis of celiac disease
Lisbeth Witt, Martin Salden, Klas Sjöberg, Fritz Koning and Yngve Sommarin (Malmö, Sweden)

- P48** CytoBead-Assay for the simultaneous detection of celiac diseases specific antibodies and IgA deficiency
Nadja Röber, Kai Grossmann, Ilka Knütter, Rico Hiemann, Mandy Sowa, Martin W. Laass, Karsten Conrad, Dirk Roggenbuck (Dresden, Germany)
- P49** The antiphospholipid antibodies in psoriasis patients with metabolic syndrome and non-alcoholic fatty liver disease comorbidities
N. Virstyuk, M. Volochynovych, M. Nykyforuk (Ivano-Frankivsk, Ukraine)
- P50** Pancreatic-specific autoantibodies to glycoprotein 2 in pediatric celiac disease
Martin W. Laass, Dirk Roggenbuck, Ursula Range, Nadja Röber, Karsten Conrad (Dresden, Germany)
- P51** Autoantibodies to Golgi complex and Ro52 protein in non-specific interstitial pneumonia (NSIP): case report and literature review
S. Andrejevic, B. Milenkovic, J. Stojsic, R. Stevic, B. Bonaci-Nikolic (Belgrade, Serbia)
- P52** Serological profile of idiopathic membranous nephropathy cohort
Astrid Behnert, Beina Teng, Janina Müller-Deile, Andrej Skoberne, Mario Schiffer, Marvin J. Fritzler (Hannover, Germany)
- P53** Our experience with anti-phospholipase A2 receptor (PLA2R) indirect Immunofluorescence test
I. Janatková, M. Hindoš, Z. Hrušková, B. Svobodová, V. Tesář, K. Malíčková, T. Zima (Prague, Czech Republic)
- P54** Detection of autoimmunity against the insulin- and insulin-like growth factor 1 receptor and their prevalence in humans
T. Welsink, C. Schwiebert, W.B. Minich, L. Schomburg (Berlin, Germany)

SUNDAY,
SEPTEMBER 01
(14.00)
UNTIL
WEDNESDAY,
SEPTEMBER 04
(13.30)

INFORMATION

Venue

The modern Center of Regenerative Therapies Dresden (CRTD) is located near to the University hospitals in the district Johannstadt.

Address of the congress venue:

CRTD

Fetscherstrasse 105

01307 Dresden

Registration office

September 01: 12.00–21.00

September 02: 08.00–18.00

September 03: 08.00–17.15

September 04: 08.00–18.00

Phone on site

+49 160 98 35 87 47 and +49 351 458 82 600

Chairman

Karsten Conrad, Germany

Co-Chairmen

Edward K. L. Chan, USA

Marvin J. Fritzler, Canada

René-Louis Humbel, Luxembourg

Pier Luigi Meroni, Italy

Günter Steiner, Austria

Yehuda Shoenfeld, Israel

International Advisory Board

Luis E.C. Andrade, Brazil

Nicola Bizzaro, Italy

Dimitrios P. Bogdanos, UK

Carlos A. Casiano, USA

Elena Csernok, Germany

Martin Herrmann, Germany

Falk Hiepe, Germany

Arno Kromminga, Germany

Michael Mahler, USA

Ger J.M. Pruijn, The Netherlands

Allan Wiik, Denmark

Tjalf Ziemssen, Germany

National Organizing Committee

Rico Hiemann

Thorsten Krieger

Robert Lange

Ulrich Sack

Werner Schöblier

(Members of the Advisory Committee of the GFID e.V.)

INFORMATION

English, no simultaneous translation

Silke Zwjatkow
GFID e.V.
Veilchenweg 28
01326 Dresden, Germany
Phone +49 351 26 32 279
Fax +49 351 26 32 280
e-mail: gfov.ev@me.com

Participants EUR 450
GFID member EUR 420
Students/Residents EUR 220
One day ticket EUR 140

(Includes unlimited access to all scientific sessions, welcome reception, industrial exhibition, one copy of the electronic edition of the conference book.)

Members of the Dresden University and the CRTD are free of charge.

Welcome reception in the Center of Regenerative Therapies Dresden (CRTD)

Social Dinner in Albrechtsberg Castle (Dresden) (90 €)

Albrechtsberg Castle was built 1850-1854 for Prince Albrecht of Prussia, which had to leave Prussia because he had married "below himself". Schloss Albrechtsberg was built in the neoclassical style, modeled on the Villa d'Este near Rome. All the builders came from Prussia, and thus the castle is an important piece of Prussian architectural history in Saxony.

Departure by bus starting from the congress venue
Musical Champagne Reception and visit of the Castle
Social Dinner (no formal dresscode)
Return by bus to the CRTD and the congress hotels

Language

Organization

(Registration, Reservation, Exhibition)

Registration fee

(on site)

Social programme

Sunday,
September 01, 2013
18.00

Tuesday,
September 03, 2013
17.15

17.15

17.45

18.30

22.00

Time Schedule

	Lecture Hall A	Lecture Hall B	Meeting rooms
Sunday, September 01			
14:00-14:30	Welcome and introduction		
14:30-16:00	Infections and autoimmunity		
16:30-18:00	Pathogenesis of autoimmune diseases – Novel aspects		
Monday, September 02			
09:00-10:20	Netosis, immunodeficiency and autoimmunity		
11:00-12:45	Autoimmunity in infections and tumors	Immune reactions against biological drugs	
12:30-14:30			EASI LUNCH MEETING (EASI members only)
14:30-15:40	Presentations of the candidates for the Dresden Prize on the Study of Autoantibodies		
16:30-17:40	Presentations of the candidates for the Dresden Prize on the Study of Autoantibodies II		
Tuesday, September 03			
09:00-10:30	Autoantibodies in connective tissue diseases	Autoantibodies in neurological diseases	
11:00-12:30	Pathogenesis and therapy of autoimmune diseases – Novel aspects	Autoantibodies in rheumatoid arthritis	
13:00-14:00			GFID meeting (GFID members only)
14:00-15:50	EASI symposium - Standardization/harmonization in autoimmune diagnostics		
16:30-17:00	Dresden Prize on the Study of Autoantibodies - Award ceremony		
Wednesday, September 04			
09:00-10:30	Methodical aspects of autoantibody testing	Paraneoplastic and tumor associated autoantibodies	
11:00-12:40	The renaissance of the HEP-2 cell assay		
13:30-15:30	EASI/GFID symposium for general practitioners (in German)		
16:00-17:30			Meeting of the German and Austrian EASI Group (in German)

Industrial exhibition (1st floor of CRTD)

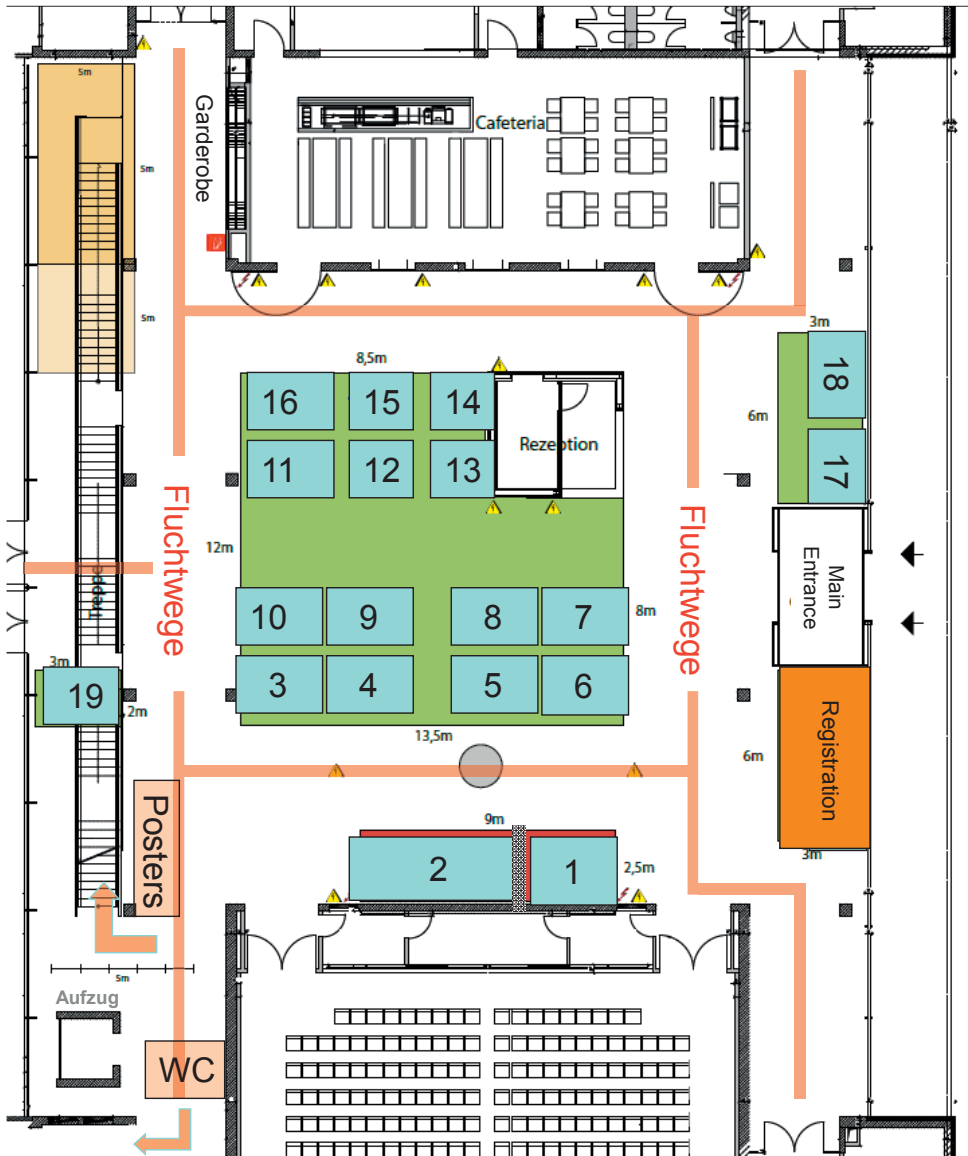

EXHIBITORS AND SPONSORS

The following companies participate in the industrial exhibition and/or have made a generous sponsoring (in alphabetical order):

A. Menarini Diagnostics Deutschland.

Division der BERLIN-CHEMIE AG (Berlin, Germany)

www.menarini.com

Aesku.Diagnostics GmbH & Co. KG

(Wendelsheim, Germany)

www.aeskulab.com

Bio-Rad Laboratories, Inc. (Hercules, USA)

www.bio-rad.com

BioSystems S.A. (Barcelona, Spain)

www.biosystems.com

Bühlmann Laboratories AG (Schönenbuch, Switzerland)

www.buhlmannlabs.ch

Diarect AG (Freiburg, Germany)

www.diarect.com

DiagnostikNet-BB e.V. (Hennigsdorf, Germany)

www.diagnostiknet-bb.de

DLD Diagnostika GmbH (Hamburg, Germany)

www.dld-diagnostika.de

Dr. Fooke-Achterrath Laboratorien GmbH

(Neuss, Germany)

www.fooke-labs.de

D-tek s.a. (Mons, Belgium)

www.d-tek.de

EUROIMMUN Medizinische Labordiagnostika AG

(Lübeck, Germany)

www.euroimmun.de

GA Generic Assays GmbH (Dahlewitz, Germany)

www.genericassays.com

hospital Laborverbund Brandenburg Berlin GmbH
(Bernau, Germany)
www.hospital-laborverbund.de

Human Gesellschaft für Biochemica und Diagnostica mbH
(Wiesbaden, Germany)
www.human.de

INOVA Diagnostics, Inc. (San Diego, USA)
www.inovadx.com

IPM Biotech GmbH (Hamburg, Germany)
www.ipm-biotech.de

LIMETEC Biotechnologies GmbH (Hennigsdorf, Germany)
www.limetec-biotechnologies.de

MBL International, Corp. (Woburn, USA)
www.mblintl.com

Medipan GmbH (Dahlewitz, Germany)
www.medipan.de

Novartis Pharma AG (Nuremberg, Germany)
www.novartispharma.de

ORGENTEC Diagnostika GmbH (Mainz, Germany)
www.orgentec.com

PEPPERPRINT GmbH (Heidelberg, Germany)
www.pepperprint.com

Phadia GmbH (Freiburg, Germany)
www.phadia.com

Protagen AG (Dortmund, Germany)
www.protagen.com

RAVO Diagnostika GmbH (Freiburg, Germany)
www.ravo.de

Seramun Diagnostica GmbH (Heidesee, Germany)
www.seramun.com

EXHIBITORS
AND
SPONSORS

The Binding Site GmbH (Schwetzingen, Germany)
www.bindingsite.de

Thieme & Frohberg GmbH (Berlin, Germany)
www.frohberg.de

Viramed Biotech AG (Plenegg, Germany)
www.viramed.de

We thank these companies for helping to make this symposium successful.

www.gfid-ev.de



OUR MEMBERS A. Menarini Diagnostics • ATLAS Biolabs • Attomol • BioTeZ Berlin-Buch • BioTOP/TSB • ThermoFisher BRAHMS • BST Bio Sensor Technology • BAM Federal Institute for Materials Research & Testing • CellTrend • Dierks + Bohle Attorneys • DMB Diagnostics • Drug Response Dx • Epiontis • ECRC Experimental & Clinical Research Center Charité • IBMT Fraunhofer Institute for Biomedical Engineering • Generic Assays • Gerdes Healthcare Communication • hospital Laborverbund Brandenburg-Berlin • Institute for Laboratory Medicine Berlin • IKDT Institute Cardiac Diagnostics & Therapy • IHP Institute for High-Performance Microelectronics • Institute for Microbiology and Epizootics/FU Berlin • ICI immunochemical intelligence • in.vent Diagnostica • LIMETEC Biotechnologies • Martina Kaufmann Strategic Consulting • MicroDiscovery • opTricon • PolyAn • predemtec • Scienion • SIFIN • University of Applied Sciences Wildau/ Institute for Biosystems Technologies • University of Potsdam • ZAB Brandenburg Economic Development Board

OUR PORTFOLIO comprises

Sample Delivery • Biobanking • Devices • Assays • Software • Bioinformatics
POCT • Personalized Medicine • Laboratory Analytics • Consulting Services

Call for Biomarkers

We are frequently looking for biomarkers to apply to the **opTrilyzer® platform** – a mobile device that quantifies lateral flow tests in a reliable fashion

You have the **BIOMARKER** We have the **PLATFORM**

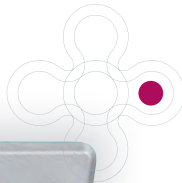

THE PACKAGE covers

- Development & validation of in-vitro diagnostics of all kind
- Epigenomic, genomic, proteomic biomarkers & cell assays
- Platform independence
- Adaptations & novel developments
- Multiplexed biomarker assays
- Point-of-care
- Companion diagnostics

ASSISTANT SERVICES include

- Supply of human materials
- Software connection

- Information technology
- Service and support
- Network in the healthcare sector

LIMETEC Biotechnologies GmbH

Neuendorfstr. 17
16761 Hennigsdorf
Germany

Telephone: (08 00) 56 00 95 02 56

Telefax: (08 00) 56 00 95 02 57

E-mail: info@limetec-biotechnologies.de

www.limetec-biotechnologies.de



LIMETEC
biotechnologies



© lightpoint - Fotolia

lab@ccess

- Web-based and independent
- Compatible with numerous interfaces
- Comprehensive interconnection
- Support of clinical and laboratory workflows*

IT platform for laboratory orders and result communication

* For example in autoimmune diagnostics

DiagConnector

powered by **DiagnostikNet | BB**

- Flexible combination of software and hardware (middleware)
- Automatic data transfer
- Compatible with HL7 and xDT



Universal and independent base station for POCT devices